

# RESERVE-TOILET ROLL HOLDER AC222



Ø 40 x 80 mm

- Reserve-toilet roll holder in solid, germ-reducing and easy-care stainless steel (AISI 303), satin finished. Further available surfaces: see below.
- Designed for one standard toilet roll with dimensions:  
Outer diameter max. 125 mm  
Width max. 100 mm  
Core diameter min. 38 mm
- Concealed, centric, anti-theft wall disc mounting.
- Holder diameter 16 mm, length 80 mm.
- Mounting with one screw.
- Delivery includes fixing material.
- Weight, including single package: 0.2 kg



## Suggested text for specifications:

Reserve-toilet roll holder in solid stainless steel (AISI 303), satin finished, for surface mounting. Concealed, centric, anti-theft wall disc mounting. Delivery includes fixing material.

Dimensions: Ø 40 x 80 mm

Article No. AC222

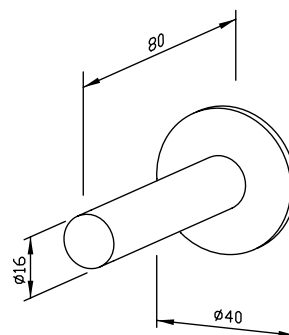

| Available surfaces        | ID No.  |
|---------------------------|---------|
| satin finished (standard) | 700 222 |
| highly polished           | 731 222 |

## Ernst Wagner GmbH & Co. KG

Ernst-Abbe-Straße 21 · D-72770 Reutlingen · Tel.: +49712151539-0 · Fax: -20  
info@wagner-ewar.de · www.wagner-ewar.de

WAGNER  
E W A R